

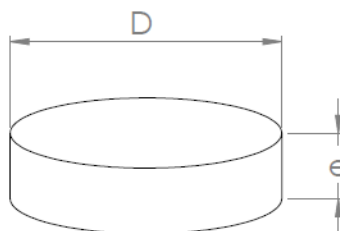

# NEODYMIUM IRON BORON



## MAGNETIC DISKS

REFERENCES	Weight [g]	Dimensions [mm]		Coating	Grades	Holding forces** [kg]	Max operating temp..***
		Ø*	e*				
<b>2412E15Z</b>	0,11	3	2	NiCuNi	N35	<b>0,22</b>	80°C
<b>2412E25Z</b>	0,35	3	6	NiCuNi	N35	<b>0,30</b>	80°C
<b>2412E45Z</b>	0,20	4	2	NiCuNi	N35	<b>0,35</b>	80°C
<b>2412E65Z</b>	0,30	5	2	NiCuNi	N35	<b>0,49</b>	80°C
<b>2452G55Z 10</b>	3,00	5	20	NiCuNi	N35	<b>3,80</b>	80°C
<b>2422D35Z 10</b>	0,85	6	4	NiCuNi	N35	<b>0,80</b>	80°C
<b>2422D45Z</b>	1,52	6	6,5	NiCuNi	N35	<b>1,09</b>	80°C
<b>2432D25Z</b>	1,25	8	3	NiCuNi	N35	<b>1,15</b>	80°C
<b>2432D05Z</b>	0,83	8	2	NiCuNi	N35	<b>0,75</b>	80°C
<b>2432D15Z</b>	1,50	8	4	NiCuNi	N35	<b>1,40</b>	80°C
<b>2413F15Z 10</b>	1,50	8	4	NiCuNi	N33SH	<b>1,30</b>	150°C
<b>2413B45Z 10</b>	1,90	8	5	NiCuNi	N35	<b>1,80</b>	80°C
<b>2432D55Z 10</b>	0,60	10	1	NiCuNi	N35	<b>0,54</b>	80°C
<b>2432D35Z</b>	1,30	10	2	NiCuNi	N35	<b>0,93</b>	80°C
<b>2412F35Z 10</b>	1,90	10	3	NiCuNi	N35	<b>1,56</b>	80°C
<b>2442E15Z</b>	2,93	10	5	NiCuNi	N35	<b>2,10</b>	80°C
<b>2412G35Z 10</b>	6,00	10	10	NiCuNi	N35	<b>3,50</b>	80°C
<b>2432E25Z</b>	1,90	12	2	NiCuNi	N35	<b>1,35</b>	80°C
<b>2401A15Z</b>	2,30	13,5	3,5	NiCuNi	N35SH	<b>2,28</b>	150°C
<b>2432E35Z</b>	4,20	13,5	6	NiCuNi	N35	<b>3,86</b>	80°C
<b>2452H45Z 10</b>	4,60	15	3,5	NiCuNi	N35	<b>2,50</b>	80°C
<b>2452E85Z</b>	6,60	15	5	NiCuNi	N35	<b>3,80</b>	80°C
<b>2412V55Z 10</b>	4,80	20	2	NiCuNi	N35	<b>2,30</b>	80°C
<b>2412Q95Z 10</b>	7,40	20	3	NiCuNi	N35	<b>3,50</b>	80°C
<b>2452E95Z</b>	31,50	22	10	NiCuNi	N35	<b>10,6</b>	80°C
<b>2452G15Z</b>	12,50	25	3	NiCuNi	N35	<b>3,90</b>	80°C
<b>2452G25Z</b>	20,30	25	5	NiCuNi	N35	<b>6,30</b>	80°C
<b>2452G35Z</b>	40,80	25	10	NiCuNi	N35	<b>10,7</b>	80°C
<b>2452F15Z</b>	45,40	38,5	5	NiCuNi	N35	<b>9,20</b>	80°C
<b>2452F25Z</b>	30,90	41	3	NiCuNi	N35	<b>6,00</b>	80°C

The axis of magnetisation is according to the thickness

\*General tolerances :  $\pm 0,1$

\*\*Indicative average value at room temperature

\*\*\*Higher temperatures are available : please contact us