

TECHNICAL FEATURES

Neodymium magnet in a PPI plastic body.

FIXING

Drill a hole of the chosen diameter according to the hardness of the panel ; push in the magnetic closure by hitting it lightly with a wooden shim.

APPLICATIONS

Ideal wooden furniture, plastic furniture...

ROUND BUILT-IN MAGNETIC SYSTEMS

REFERENCES	Dimensions [mm]				Holding force* [kg]	Color
	D	B	H	E		
2500CB5Z	9,6	8,5	9,6	1	1	Black
2500CN5Z	9,6	8,5	9,6	1	1	White
2501CB5Z	13,5	11,7	10,5	1	1,4	Black
2501CN5Z	13,5	11,7	10,5	1	1,4	White

* Indicative average value at room temperature

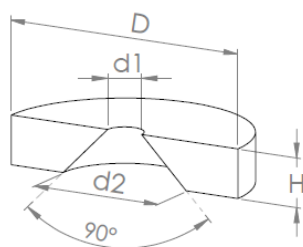

MATERIAL

Cr coated steel

FIXING

User a countersunk screw ; be careful not to block the counter-plate when installing it to allow some clearance to be absorbed

APPLICATIONS

Counter plate for furniture and other applications

COUNTER PLATE FOR ROUND BUILT-IN MAGNETIC SYSTEMS

REFERENCES	Dimensions [mm]				Coating
	D	H	d1	d2	
49G00300	15 ±0,1	3 ±0,1	3,2 ±0,1	7 ±0,5	Cr
49G00200	28 ±0,1	5,5 ±0,1	4,2 ±0,1	9,5 ±0,5	Cr
49G00100	27 ±0,1	3 ±0,1	5,7 ±0,1	11,7 ±0,5	Cr
8901607000	27 +0,6/-0	3 ±0,1	5,5 ±0,3	11.5 ±0,3	Stainless steel